

POS.	COD.	Pz.	DESCRIZIONE	DESCRIPTION	DESCRIPTION	BESCHREIBUNG	DESCRIPCIÓN
1	R70050170	1	GUARNIZIONE TUBO SFIATO 80x40	GASKET 80x40	JOINT 80x40	DICHTUNG 80X40	JUNTA 80X40
2	R58007330	1	ASTA FARFALLA SFIATO SERIE ICON 2015	CHAMBER VENT PLATE	ENTFEUCHTUNGSSCHIEBER	DISQUE EVENT	DISCO RESPIRADERO
3	R65090270	1	PROGRAMMATORE V230/50-60Hz	DAMPER SYSTEM	SORTIE EVAPORATION MOUFLE	DAMPFABLASS-STELLMOTOR	MOTOR RESPIRADERO COMPLETO
4	R70050200	1	GUARNIZIONE ESTERNA TUBO SFIATO 80X40	EXTERNAL GASKET 80x40	JOINT 80x40	RINGDICHTUNG 80X40	JUNTA 80X40
5	R65041040	2	MOTORE 1F.125Win-75Wout 2VEL C/COND. FIR	MOTOR 1F.125Win-75Wout	MOTEUR 1F.125Win-75Wout	MOTOR 1F.125Win-75Wout	MOTOR 1F.125Win-75Wout
6	R58005500	2	SEDE PER "TENUTA D.8/22X7" A 04-05	MOTOR GASKET BRASS FLANGE	BRIDE JOINT MOTEUR	FLANSCH F. MOTORDICHTUNG	BRIDA JUNTA MOTOR
7	R70020020	2	GUARNIZIONE DI TENUTA A 04 BAD40 8X22	OR GASKETS	JOINT	RINGDICHTUNG	JUNTA
8	R65011780	2	RESISTENZA 6000W 230V C/FASTON CAM. ICON 2015	HEATING ELEMENT 7000W 230V	RESISTANCE 7000W 230V	HEIZKOERPER 7000W 230V	RESISTENCIA 7000W 230V
9	R75400410	2	VENTOLA D.180X77/12 50 HZ P.D.	FAN D.180X77/12 50 HZ P.D.	TURBINE D.180X77/12 50 HZ P.D.	LUEFTERRAD D.180X77/12 50 HZ P.D.	PALA VENTILADOR D.180X77/12 50 HZ P.D.
10	R75300160	2	GRIGLIA VENTILATORE D.180	FAN GUARD GRID D.180	GRILLE VENTILATEUR D.180	VENTILATORSCHUTZGITTER D.180	REJILLA VENTILADOR D.180
11	R58007250	1	CERNIERA SUPERIORE PIANA SERIE ICON 2015	UPPER DOOR HINGE ICON 2015	CHARNIERE SUPERIEURE PORTE ICON 2015	OBERES SCHARNIER ICON 2015	BISAGRA SUPERIOR ICON 2015
12	R58007260	1	CERNIERA INFERIORE PIANA SERIE ICON 2015	LOWER DOOR HINGE ICON 2015	CHARNIERE INFERIEURE PORTE ICON 2015	UNTERES SCHARNIER ICON 2015	BISAGRA INFERIOR ICON 2015
13	R58007280	1	PERNO CERNIERA PORTA DX SERIE ICON 2015	HINGE PIN ICON 2015 - RIGHT DOOR	CHEVILLE CHARNIERE ICON 2015 - PORTE DX	SCHARNIERSTIFT ICON 2015 - TUR DX	PERNO BISAGRA ICON 2015 - PUERTA DX
13	R58007290	1	PERNO CERNIERA PORTA SX SERIE ICON 2015 - PORTA CONTRARIA	HINGE PIN ICON 2015 - LEFT DOOR	CHEVILLE CHARNIERE ICON 2015 - PORTE SX	SCHARNIERSTIFT ICON 2015 - TUR SX	PERNO BISAGRA ICON 2015 - PUERTA SX
14	R69130570	2	TAPPO CHIUDIFORO D.8,5-14,5	COVER D.8,5-14,5	BOUCHON D.8,5-14,5	ABDECKUNG D.8,5-14,5	TAPON D.8,5-14,5
15	R58007270	1	TAMPONAM. CERNIERA INF.SERIE ICON 2015	CLOSING PLATE LOWER DOOR HINGE ICON 2015	TÔLE DE FERMETURE CHARNIERE INFERIEURE PORTE ICON 2015	VERSCHLUBLEISTE UNTERES SCHARNIER ICON 2015	PLACA DE CIERRE BISAGRA INFERIOR ICON 2015
16	R69180260	1	BACINELLA SCARICO FORNO ICON 2015	DRIP TRAY - ICON 2015	PLATEAU D'ÉGOUTTEMENT - ICON 2015	WASSERTROPFTASSE - ICON 2015	BANDEJA DEL GOTEO - ICON 2015
17	R69180310	3	TAPPO VITE BACINELLA SCARICO ICON 2015	COVER	BOUCHON	ABDECKUNG	TAPON
18	R69010260	1	NASELLO 1 STEP	DOOR LATCH 1 STEP	GACHE DE PORTE POUR OUVERTURE SIMPLE	SCHLISSNASE 1 STUFE	NARIZ 1 CIERRE
19	R70044430	1	TELAIO GUARN. PORTA REP 064/074	FRONT GASKET	JOINT FACADE	DICHTUNG DER FRONTSEITE	JUNTA FRONTAL
20	R58007340	8	PERNO SUPP. PARATIE A FILO M5 ICON 2015	SIDE RUNNERS SUPPORT	SUPPORT GLISSIERES	BOLZEN AUFLAGESCHIENEN	PERNO PARATIA
21	R10201700	1	ASS. FILTRO DI SCARICO D.76/44,5 M/106-11	DRAIN FILTER	FILTRE ENCEINTE	ABFLUSSFILTER	FILTRO DESAGUE
22	R70010140	1	GUARNIZIONE SILICONE ROSSO 76x40,3x3	RED GASKET 76x40,3x3	ROUGE JOINT 76x40,3x3	ROTEN DICHTUNG 76x40,3x3	JUNTA ROJA 76x40,3x3
23	R65320220	2	SONDA "K" 6X80 1,5ML. TESTA RASTREM. 20mm	PROBE "K" 6X80 1,5ML.	SONDE "K" 6X80 1,5ML.	FUEHLER "K" 6X80 1,5ML.	SONDA "K" 6X80 1,5ML.
24	R62070023	2	BICONO PILOTA TUBO D.6	BICONE D.6	BICONE D. 6	KEGEL D.6	BICONO D.6
25	R62060223	2	DADO PILOTA TUBO D.6	NUT D.6	ECROU D. 6	MUTTER D.6	DADO D.6
26	R62280028	1	CURVA C/MORSET. HTS-HTSW X TUBO D.40 D.40X	CURVE WITH TERMINAL	COURBE AVEC BORNIER	KURVE MIT KLEMM	CURVA CON REGLETERA
27	R65110500	2	REGOL. PORTATA MARRONE 8lt/h	8 LT/H WATER FLOW REDUCER	REGULATUER DE DEBIT 8 LT.	DURCHFLUSSMONDERER 8L/STD.	REGULADOR DE CAUDAL 8 LT.
28	R63070050	1	PRESSOSTATO 1/8" 0,5-0,35 BAR PH/91140	WATER SAFETY PRESSURE SWITCH	INT.A PRESSION SEC.-EAU	WASSER-DRUCKWACHTER	PRESOSTATO AQUA
29	R62030113	1	MANICOTTO RIDUZ. FF 1/8-1/4 OTTONE	REDUCTION COUPLING	MANCHON REDUCTION	REDUZIERMUFFE	MANGUITO REDUCCION
30	R62090508	2	RACC.TERMIN.DIR.FIL.CON.10X1/4	10X1/4 STRAIGHT THREADED TERMINAL PIPE FITTING	RACCORDEMENT	ENDVERBINDUNGSSTUCK 10 X 1/4" GESCHNITTEN	RACOR
31	R62090788	2	RIDUZIONE INTER.DRITTA ø10-ø6	REDUCTION PIPE FITTING	RACCORD DROIT REDUCTION	GERADE ANSCHLUSS-VERKLEINERUNG	RACOR DERECHO REDUCCION
32	R65110240	1	E.V. 3VIE 2P+1D 220V/50HZ CON ATTACC	SOLENOID VALVE 2 VIE 220V 50HZ	ELECTROVANNE 2 VIE 220V 50HZ	MAGNETVENTIL 2 VIE 220V 50HZ	ELECTROVALVULA 2 VIE 220V 50HZ
33	R65240200	1	PRESSACAVO V-TEC 21 NERO	FAIRLEAD	PRESSE CABLE	ZUGENTLASTUNG	PRENSACABLES
34	R65240210	1	CONTRODADO 116/21 N	LOCK NUT	CONTRE-ECROU	MUTTER	CONTRODADO
35	R69070170	4	PIEDE REG.1" 3/4 A304 C/VITE M10X25 PCN	FOOT WITH SCREW M10X25 PCN	PIED AVEC VIS M10X25 PCN	FUSS MIT SCHRAUBE M10X25 PCN	PATA CON TORNILLO M10X25 PCN

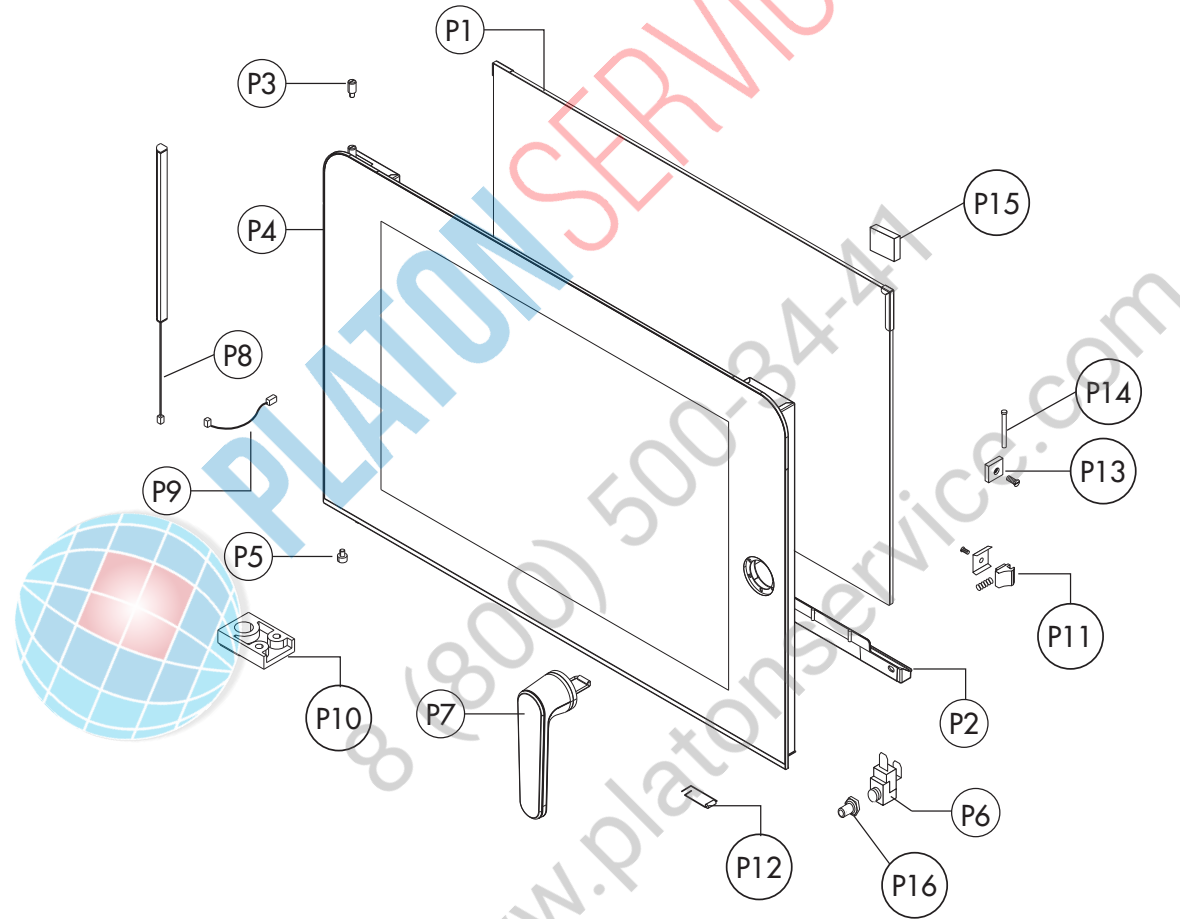

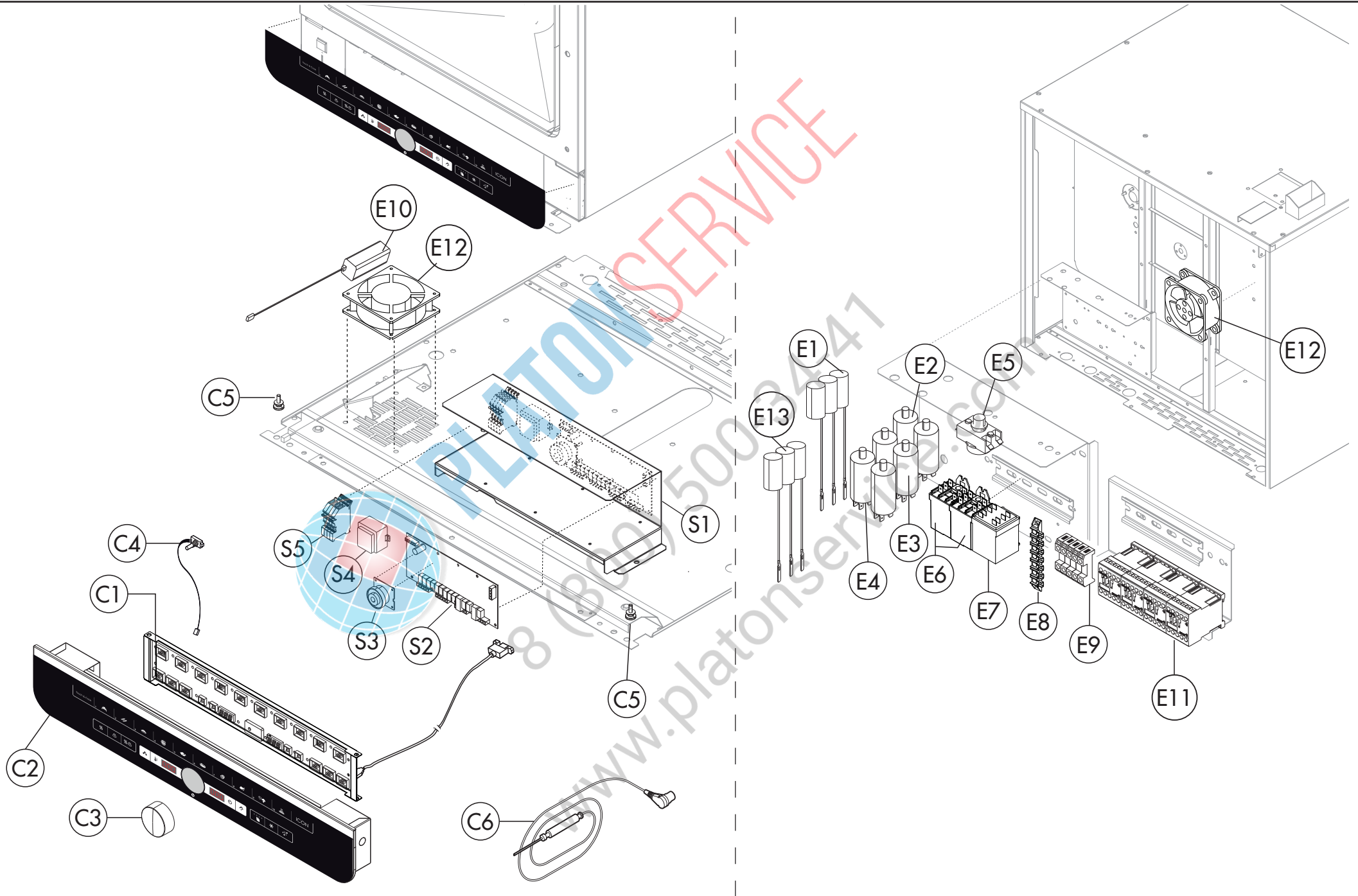

POS.	COD.	Pz.	DESCRIZIONE	DESCRIPTION	DESCRIPTION	BESCHREIBUNG	DESCRIPCIÓN
CRUSCOTTO ELETTRICO / ELECTRONIC CONTROL PANEL / CONTRÔLE ÉLECTRONIQUE / ELEKTRONISCHE STEUEREINHEIT / PANEL DE CONTROL							
C1	R65302660	1	SCHEDA TASTIERA TOUCH ICON 2015 + CAVO	REALY PC BOARD ICON 2015 + CABLE	FICHE PANNEAU COMMANDES ICON 2015	TASTAURPLATINE ICON 2015	PLACA PULSADORES ICON 2015
C2	R17410690T1	1	CRUSCOTTO + VETRO IC_T051 - 71 - 101 LAINOX	DISPLAY + GLASS IC_T051-71-101 LAINOX	DISPLAY + VITRE IC_T051-71-101 LAINOX	DISPLAY + GLASS IC_T051-71-101 LAINOX	DISPLAY + VIDRIO IC_T051-71-101 LAINOX
C2	R17410690T1A	1	CRUSCOTTO + VETRO IC_T051 - 71 - 101 ALPH-NEUTRO	DISPLAY + GLASS IC_T051-71-101 ALPH-NEUTRO	DISPLAY + VITRE IC_T051-71-101 ALPH-NEUTRO	DISPLAY + GLASS IC_T051-71-101 ALPH-NEUTRO	DISPLAY + VIDRIO IC_T051-71-101 ALPH-NEUTRO
C3	R69030340	1	MANOPOLA ICON 2015	KNOB KIT ICON 2015	POIGNEE COMMANDE ICON 2015	DREHKNOFF ICON 2015	PULSADOR MANETA ICON 2015
C4	R65302720	1	ENCODER + CAVO ICON	ENCODER + CABLE	ENCODER + CABLE	ENCODER + KABEL	ENCODER + CABLE
C5	R69010990	2	MANOPOLA M4 FISSAGGIO CRUSCOTTI ICON	DISPLAY SCREW	VIS DE BLOCAGE DISPLAY	SCHRAUBE FÜR DISPLAY	TORNILLO FIJACION DISPLAY
C6	R65321430	1	SONDA AL CUORE K4P ISC04 (6 PIN,PC PLAS.)	CORE TEMPERATURE PROBE	SONDE A COEUR	KERNTEMPERATURFUEHLER	SONDA AL CORAZON
SCHEDA BASE / MAIN PC BOARD / FICHE PANNEAU PRINCIPAL / HAUPTPLATINE / PLACA BASE							
S1	R17108090	1	SCHEDA BASE COMPLETA ICON TOUCH	MAIN PC BOARD ICON 2015	FICHE PANNEAU PRINCIPAL ICON 2015	HAUPTPLATINE ICON 2015	PLACA BASE ICON 2015
S2	R65302670	1	SCHEDA BASE TOUCH ICON 2015	MAIN PC BOARD ICON 2015	FICHE PANNEAU PRINCIPAL ICON 2015	HAUPTPLATINE ICON 2015	PLACA BASE ICON 2015
S3	R65302680	1	SCHEDA BUZZER ICON 2015	PC BOARD BUZZER ICON 2015	SONNERIE PLATINE ICON 2015	PLATINENSUMMER ICON 2015	ZUMBADOR PLACA ELECTRONICA ICON 2015
S4	R65180420	1	TRASFERE 20VA 0-220-240/12V	TRANSFORMER 20VA 0-220-240/12V	TRANSFORMATEUR 20VA 0-220-240/12V	TRANSFORMATOR 20VA 0-220-240/12V	TRANSFORMADOR 20VA 0-220-240/12V
S5	R65210020	4	PORTAFUSIBILE BARRA DIN 5x20	FUSE CARRIER	PORTE-FUSIBLE	SICHERUNGSHALTER	PORTAFUSIBLE
COMPONENTI ELETTRICI / ELECTRONIC COMPONENTS / COMPOSANTS ÉLÉTRIQUES / ELEKTRISCHE BAUTEILE / COMPONENTES ELÉTRICOS							
E1	R65280200	3	FILTRO Cx=0,47µ F Cy=2X10nf	INTERFERENCE SUPPRESSOR	FILTRE ANTIPARASITES	STOERSCHUTZFILTER	FILTRO
E2	R65190080	2	CONDENS. 5µF V425-B C/CAP.C/COD.	CAPACITOR 5µF	CONDENSATEUR 5µF	KONDENSATOR 5µF	CONDENSADOR 5µF
E3*	R65190240	2	CONDENSATORE 10µF C/USCITA 4 FASTON 6,35	CAPACITOR 10µF	CONDENSATEUR 10µF	KONDENSATOR 10µF	CONDENSADOR 10µF
E4	R65190220	2	CONDENSATORE 0,47µF 275V	CAPACITOR 0,47µF 275V	CONDENSATEUR 0,47µF 275V	KONDENSATOR 0,47µF 275V	CONDENSADOR 0,47µF 275V
E5	R65070450	1	TERMOST. SICUR. BIP. 335 ø C NEGAT.	THERMOSTAT	THERMOSTAT	THERMOSTAT	TERMOSTATO
E6	R65170180	2	RELÉ FINDER	RELAY	RELAIS	RELAIS	RELE
E7	R65170170	1	RELE' FINDER CONT.SCAMB.	RELAY	RELAIS	RELAIS	RELE
E8	R65220360	1	MORSETTIERA A VITE 7 POLI	TERMINAL	BORNE	KLEMMME	REGLETA
E9	R65220091	1	MORSETTIERA LX2E (TIPO 2) NEW	TERMINAL BOARD	BORNIER	KLEMMLEISTE	REGLETERA
E10	R65187220	1	ALIMENTATORE APV-12-24	POWER SUPPLY	BLOC D'ALIMENTATION	NETZTEIL	ADAPTADOR DE CORRIENTE ALTERNA
E11	R65140700	4	TELERUTTORE DIL M9-01 4 KW-20 A	CONTACTOR	CONTACTEUR	SCHUETZ	CONTACTOR
E12	R65060050	2	VENTILATORE COMPATTO D.120	COMPONENTS VENTILATION MOTOR D.120	MOTEUR DE REFROIDISSMENT D.120	ABKULUNGS MOTOR D.120	MOTOR DE ENFRIAMIENTO D.120
E13*	R65280260	3	FILTRO	INTERFERENCE SUPPRESSOR	FILTRE ANTIPARASITES	STOERSCHUTZFILTER	FILTRO

* PER GLI ICET071 230/1/50 2 VEL - FOR ICET071 230/1/50 2 VEL - POUR ICET071 230/1/50 2 VEL - FÜR ICET071 230/1/50 2 VEL - POR ICET071 230/1/50 2 VEL

